

Scale 20 rods = 1 inch

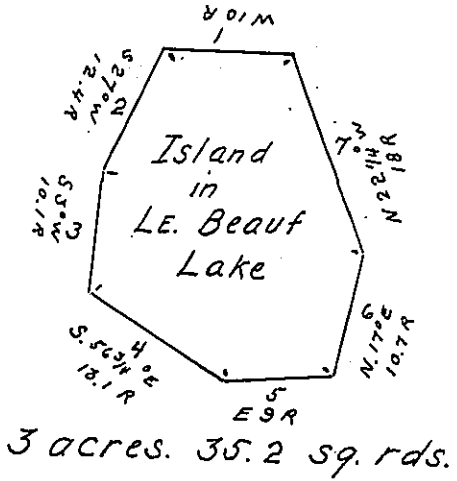

A Draft of an island situated ^{Lake Le Boeuf} in the Township of Waterford and County of Erie containing 3 Acres ^{strict measure} acres & 35.2 perches ~~and allowance of six per cent for roads etc.~~ Surveyed the 23rd day of November 1894. in pursuance of a warrant granted to A. J. Cowan dated the 10th day of September 1894.

To Thomas J. Stewart, Esq., } Irvin Camp
 Secretary of Internal Affairs } County Surveyor.

IN TESTIMONY that the above is a copy of the original remaining on file in the Department of Internal Affairs of Pennsylvania, made conformably to an Act of Assembly approved the 16th day of February, 1833, I have hereunto set my Hand and caused the Seal of said Department to be affixed at Harrisburg, this fourteenth day of July 1904

Lucas R. Brown
 Secretary of Internal Affairs.